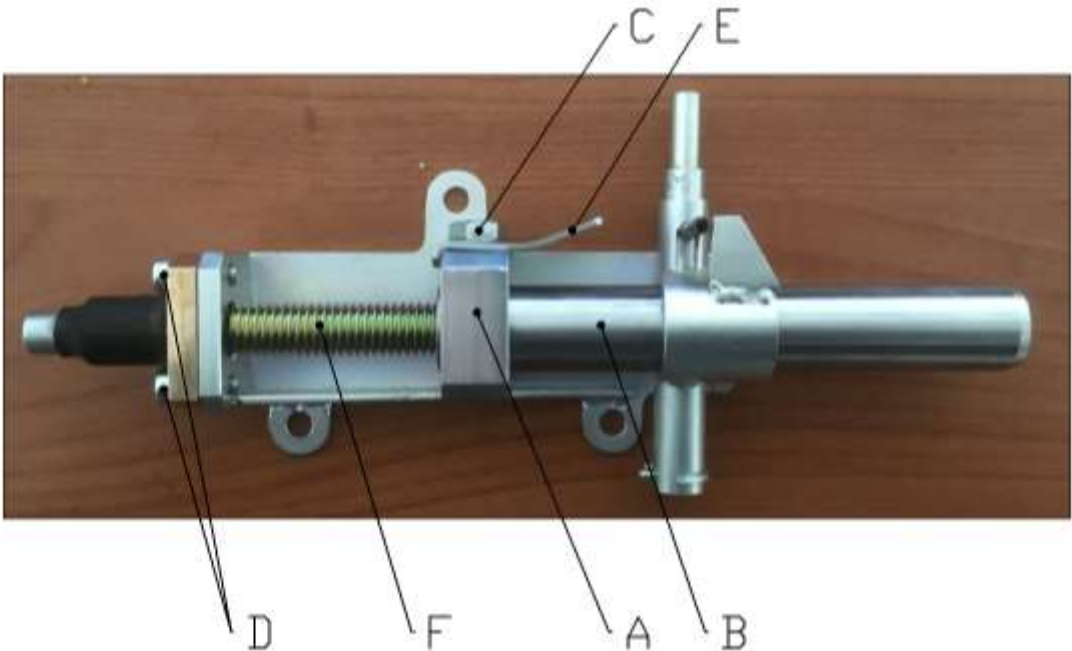
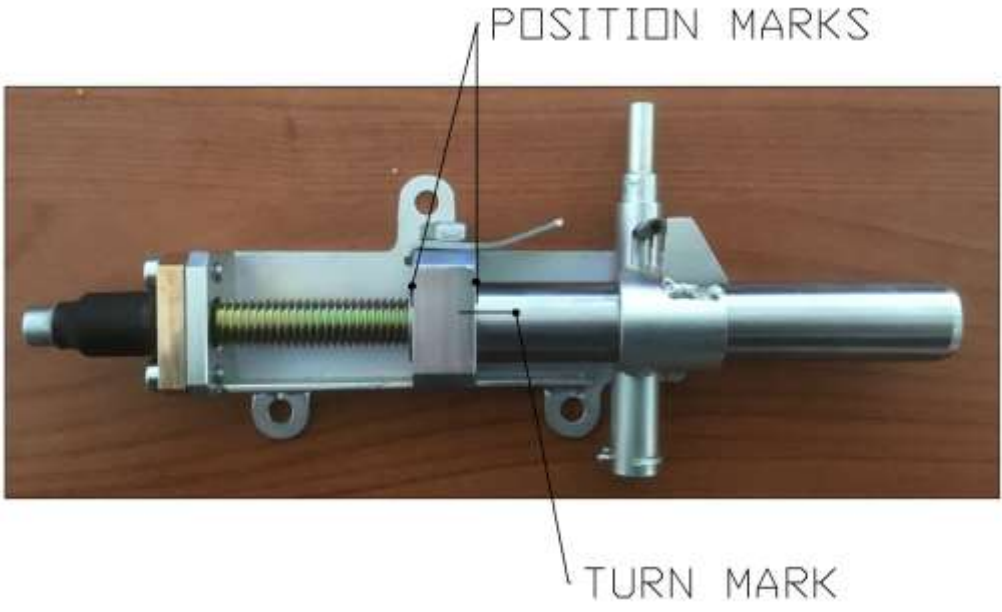
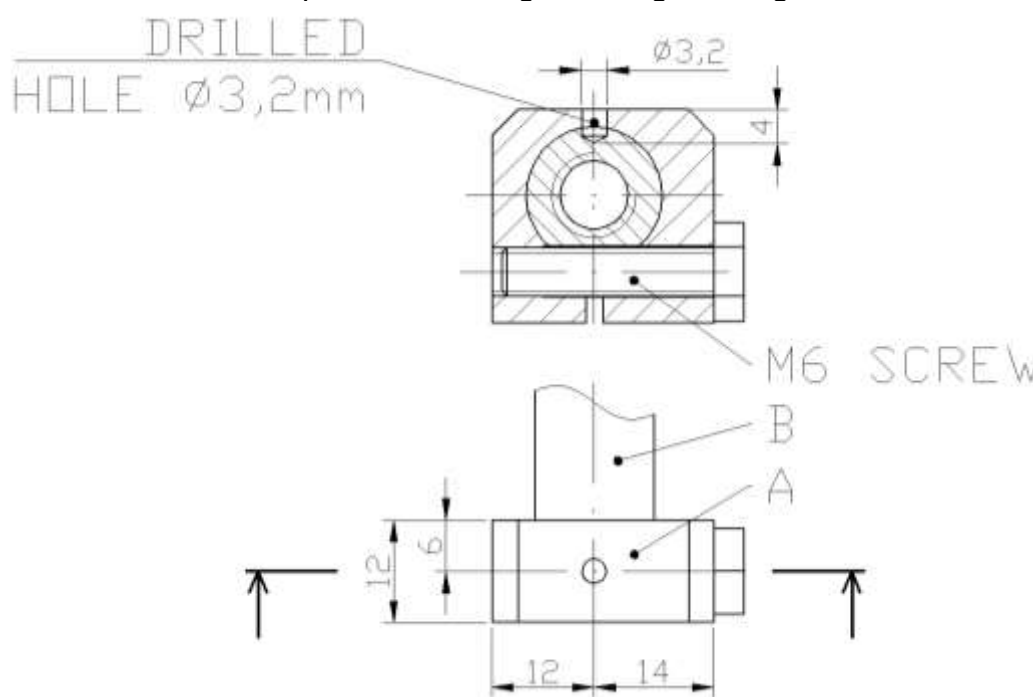
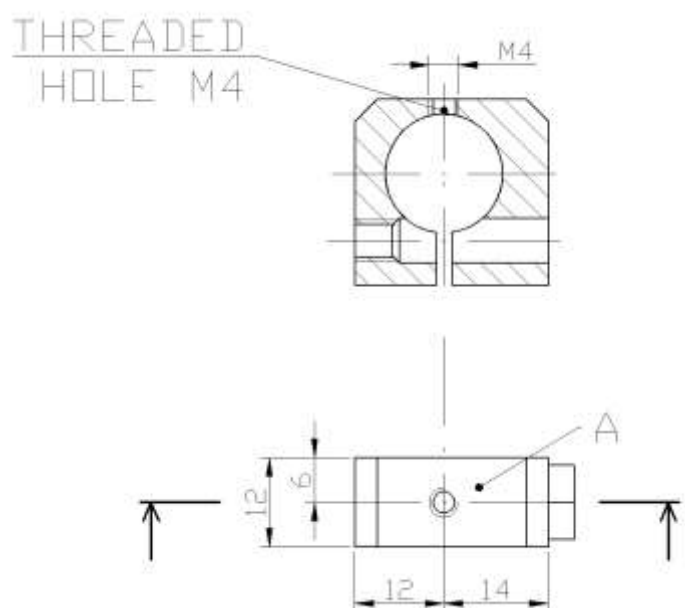

Part	quantity
Parts for installation	
Securing screw M4x6 DIN914	2
Additional equipment	
Drill diameter 3,2mm	
Pedestal drilling machine	
Screw-tap M4	
Wrench 10mm	
Allen key 3mm and 2mm	
Loctite 241	
Screw position marker	
Wing extension installation tool	

No.:	Postup instalace
1	Remove wing extension and clean pin and pin mechanism used for wing extension securing.
2	<p>Using standard tool for wing extension removing set mechanism to the middle position. As shown on the following figure.</p> 
3	<p>Mark position of the part A on the pin B by the same way as marked (2 axial + 1 radial marks).</p> 

4	Loose the screw C (several turns) and turn the thread rod (using standard tool for wing tip installation) to push the pin B out of the part A. Then remove the pin out of the wing (towards trailing edge).
5	Unscrew two screws D and shift thread rod F towards the leading edge. Then remove part A.
6	Out of the wing, assembly part A and pin B together again. Use marking made in point 4. Tighten screw M6 (C) to hold parts A and B.
7	<p>Mark position of a hole on the part A according following drawing.</p> 
8	Drill the hole $\text{Ø}3,2\text{mm}$ in depth of 4mm (through part A and pin B - see drawing in the point 8). The depth of the hole cannot exceed 4,5mm otherwise a thread inside pin B may be damaged.
9	Disassemble part A and pin B assembly. Hold part A (using a clamp) and cut tread M4 in the hole $\text{Ø}3.2\text{mm}$.

	
10	Clean all parts of mechanism especially part A and pin B. Do not remove the position markings on the pin B and part A.
11	<p>Assemble mechanism inside the wing:</p> <ul style="list-style-type: none"> - attach sheet E to part A using M6 screw C, do not tighten - hold part A at its position at the frame and slip the thread rod F through the part A. - tighten screws D, to fix tread rod <ul style="list-style-type: none"> - insert pin B through housings and screw it on the threaded rod F - using standard tool for wing extension removing set the pin B in to the middle position - assemble Part A together with the pin B (according previous marking) and tighten M6 screw C - secure the screw using Loctite 241
12	Install securing screw M4 according following drawing. Secure with Loctite 241

M4x6 DIN914

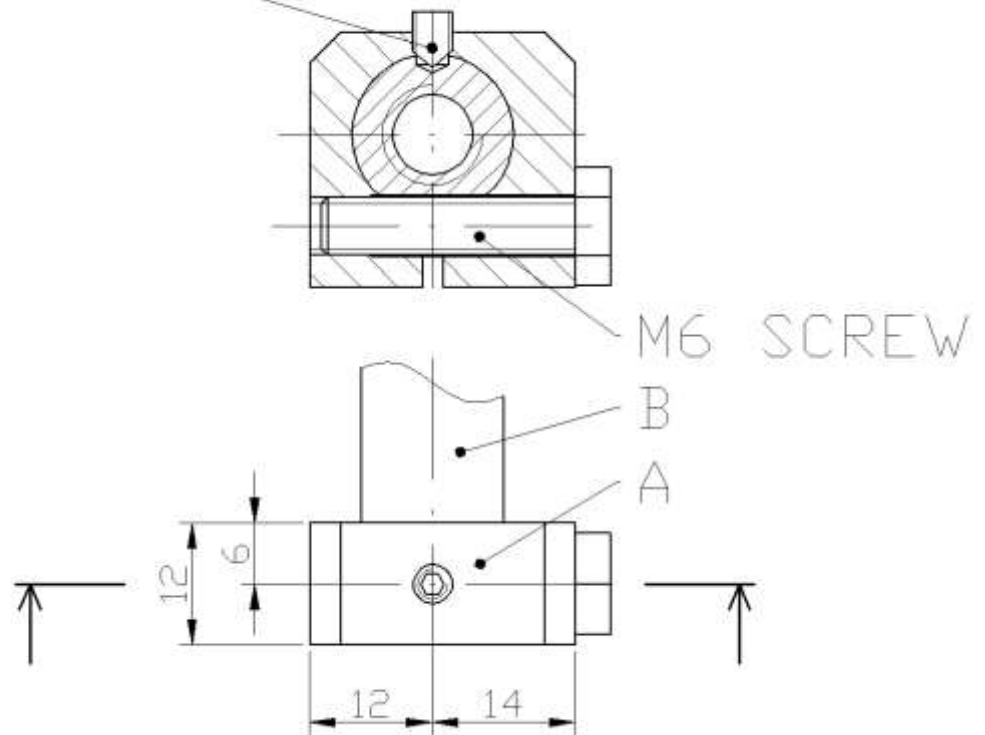

- 13** Check the mechanism function and grease pin B and thread rod F (wing tip not installed).
- 14** Mark position of M6 screw C and securing screw M4